

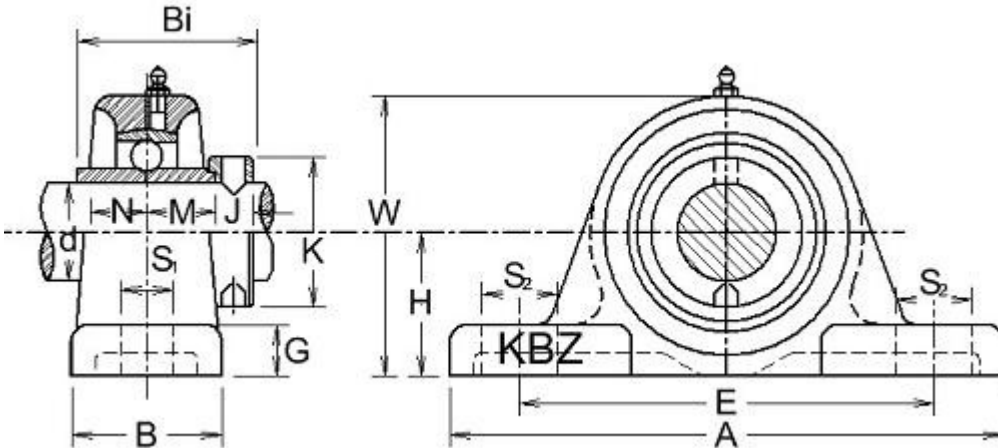

NAP Pillow Blocks

Normal Duty



- Cast Iron Housing
- Wide Inner Race
- SR-type or L3-type Seals
- Standard Shaft Height
- Eccentric Locking Collar

| Unit No. | Shaft Dia. | | Dimensions (in.) (mm) | | | | | | | | | | | Bolt Used (in.) | Bearing Housing No. | | | |
|------------|------------|------|-----------------------|--------|-------|-------|-------|-------|-------|-------|-------|-------|-------|-----------------|---------------------|---|-----|-----------|
| | (in.) | (mm) | H | A | E | B | S2 | S1 | G | W | Bi | N | M | | | J | K | |
| NAP 201 | | 12 | | | | | | | | | | | | | | | | NA 201 |
| 201-8 | 1/2 | 15 | 1.188 | 5 | 3.779 | 1.417 | 0.748 | 0.512 | 0.532 | 2.359 | 1.713 | 0.669 | 0.669 | 0.374 | 1.311 | | 3/8 | NA 201-8 |
| 202 | | 15 | 30.2 | 127 | 96 | 36 | 19 | 13 | 13 | 60 | 43.5 | 17 | 17 | 9.5 | 33.3 | | | P 203 |
| 202-10 | 5/8 | 17 | | | | | | | | | | | | | | | | NA 202-10 |
| 203 | | 17 | | | | | | | | | | | | | | | | 203 |
| NAP 204-12 | 3/4 | 20 | 1.313 | 5 | 3.75 | 1.5 | 0.748 | 0.512 | 0.563 | 2.559 | 1.713 | 0.669 | 0.669 | 0.374 | 1.311 | | 3/8 | NA 204-12 |
| 204 | | 20 | 33.3 | 127 | 95 | 38 | 19 | 13 | 14 | 65 | 43.5 | 17 | 17 | 9.5 | 33.3 | | | P 204 |
| NAP 205-14 | 7/8 | 25 | 1.438 | 5.5 | 4.125 | 1.5 | 0.748 | 0.512 | 0.591 | 2.795 | 1.744 | 0.685 | 0.685 | 0.374 | 1.5 | | 3/8 | NA 205-14 |
| 205-15 | 15/16 | 25 | 36.5 | 140 | 105 | 38 | 19 | 13 | 15 | 71 | 44.3 | 17.4 | 17.4 | 9.5 | 38.1 | | | P 205 |
| 205 | | 25 | | | | | | | | | | | | | | | | 205 |
| 205-16 | 1 | 25 | | | | | | | | | | | | | | | | 205-16 |
| NAP 206-17 | 1 1/16 | 30 | 1.688 | 6.344 | 4.75 | 1.889 | 0.827 | 0.669 | 0.669 | 3.268 | 1.902 | 0.717 | 0.717 | 0.469 | 1.752 | | 1/2 | NA 206-17 |
| 206-18 | 1 1/8 | 30 | 42.9 | 161 | 121 | 48 | 21 | 17 | 17 | 83 | 48.3 | 18.2 | 18.2 | 11.9 | 44.5 | | | P 206 |
| 206 | | 30 | | | | | | | | | | | | | | | | 206 |
| 206-19 | 1 3/16 | 30 | | | | | | | | | | | | | | | | 206-19 |
| 206-20 | 1 1/4S | 30 | | | | | | | | | | | | | | | | 206-20 |
| NAP 207-20 | 1 1/4 | 35 | 1.875 | 6.594 | 5 | 1.889 | 0.827 | 0.669 | 0.708 | 3.661 | 2.012 | 0.74 | 0.74 | 0.532 | 2.189 | | 1/2 | NA 207-20 |
| 207-21 | 1 5/16 | 35 | 47.6 | 167 | 127 | 48 | 21 | 17 | 18 | 93 | 51.1 | 18.8 | 18.8 | 13.5 | 55.6 | | | P 207 |
| 207-22 | 1 3/8 | 35 | | | | | | | | | | | | | | | | 207-22 |
| 207 | | 35 | | | | | | | | | | | | | | | | 207 |
| 207-23 | 1 7/16 | 35 | | | | | | | | | | | | | | | | 207-23 |
| NAP 208-24 | 1 1/2 | 40 | 1.936 | 7.125 | 5.438 | 2.126 | 0.827 | 0.669 | 0.708 | 3.858 | 2.217 | 0.843 | 0.843 | 0.532 | 2.374 | | 1/2 | NA 208-24 |
| 208-25 | 1 9/16 | 40 | 49.2 | 181 | 137 | 54 | 21 | 17 | 18 | 98 | 56.3 | 21.4 | 21.4 | 13.5 | 60.3 | | | P 208 |
| 208 | | 40 | | | | | | | | | | | | | | | | 208 |
| NAP 209-26 | 1 5/8 | 45 | 2.125 | 7.5 | 5.75 | 2.126 | 0.827 | 0.669 | 0.708 | 4.173 | 2.217 | 0.843 | 0.843 | 0.532 | 2.5 | | 1/2 | NA 209-26 |
| 209-27 | 1 11/16 | 45 | 54.0 | 191 | 146 | 54 | 21 | 17 | 18 | 106 | 56.3 | 21.4 | 21.4 | 13.5 | 63.5 | | | P 209 |
| 209-28 | 1 3/4 | 45 | | | | | | | | | | | | | | | | 209-28 |
| 209 | | 45 | | | | | | | | | | | | | | | | 209 |
| NAP 210-30 | 1 7/8 | 50 | 2.25 | 8.031 | 6.25 | 2.362 | 0.984 | 0.787 | 0.827 | 4.488 | 2.469 | 0.969 | 0.969 | 0.532 | 2.752 | | 5/8 | NA 210-30 |
| 210-31 | 1 15/16 | 50 | 57.2 | 204 | 159 | 60 | 25 | 20 | 21 | 114 | 62.7 | 24.6 | 24.6 | 13.5 | 69.9 | | | P 210 |
| 210 | | 50 | | | | | | | | | | | | | | | | 210 |
| 210-32 | 2S | 50 | | | | | | | | | | | | | | | | 210-32 |
| NAP 211-32 | 2 | 55 | 2.5 | 8.625 | 7 | 2.362 | 0.984 | 0.787 | 0.906 | 4.906 | 2.811 | 1.091 | 1.091 | 0.63 | 3.0 | | 5/8 | NA 211-30 |
| 211-34 | 2 1/8 | 55 | 63.5 | 219 | 178 | 60 | 25 | 20 | 23 | 126 | 71.4 | 27.7 | 27.7 | 16.0 | 76.2 | | | P 211 |
| 211 | | 55 | | | | | | | | | | | | | | | | 211 |
| 211-35 | 2 3/16 | 55 | | | | | | | | | | | | | | | | 211-35 |
| NAP 212-36 | 2 1/4 | 60 | 2.75 | 9.436 | 7.375 | 2.756 | 0.984 | 0.787 | 0.984 | 5.433 | 3.063 | 1.217 | 1.217 | 0.63 | 3.315 | | 5/8 | NA 212-36 |
| 212 | | 60 | 69.8 | 240 | 187 | 70 | 25 | 20 | 25 | 138 | 77.8 | 30.9 | 30.9 | 16.0 | 84.2 | | | P 212 |
| 212-38 | 2 3/8 | 60 | | | | | | | | | | | | | | | | 212-38 |
| 212-39 | 2 7/16 | 60 | | | | | | | | | | | | | | | | 212-39 |
| NAP 213-40 | 2 1/2 | 65 | 3 | 9.75 | 7.625 | 2.756 | 1.181 | 0.984 | 1.063 | 5.945 | 3.374 | 1.343 | 1.343 | 0.689 | 3.386 | | 5/8 | NA 213-40 |
| 213 | | 65 | 76.2 | 248 | 194 | 70 | 30 | 25 | 27 | 151 | 85.7 | 34.1 | 34.1 | 17.5 | 86.0 | | | P 213 |
| NAP 215-47 | 2 15/16 | 75 | 3.25 | 10.188 | 8.5 | 2.913 | 1.181 | 0.984 | 1.102 | 6.417 | 3.626 | 1.469 | 1.469 | 0.689 | 4.016 | | 7/8 | NA 215-47 |
| 215 | | 75 | 82.6 | 275 | 217 | 74 | 30 | 25 | 28 | 163 | 92.1 | 37.3 | 37.3 | 17.5 | 102.0 | | | P 215 |
| 215-48 | 3 | 75 | | | | | | | | | | | | | | | | 215-48 |